

## Basic CSS layout with Dreamweaver

© nigelbuckner.com 2011

This handout covers the procedure for producing a layout like the one illustrated below and how it can be populated with content.

This layout is based on a common method of using <div> tags to create a layout. There are no *position* properties used in the styles. This layout uses the method of floating the layout within the centre of the browser window.

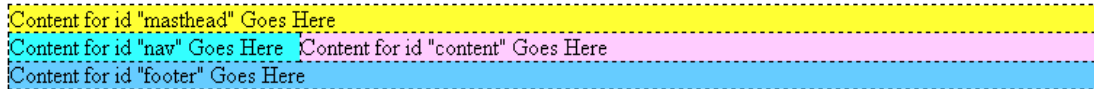

*Layout after alignment of div tags with styles and prior to populating with content*

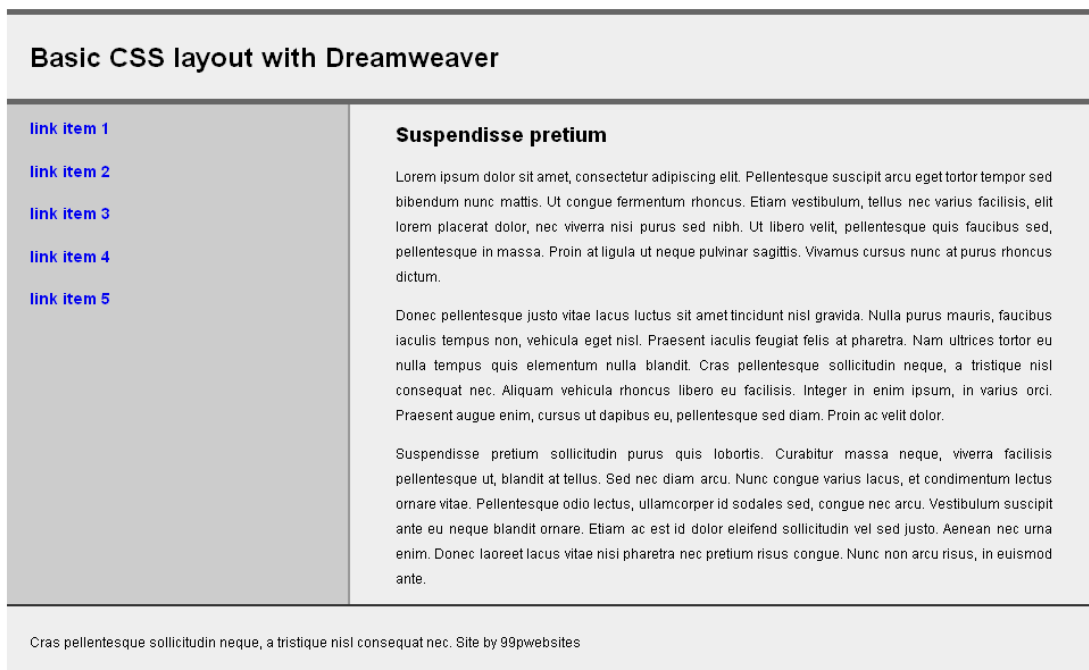

*Layout after populating with content and further styling. The CSS for this is on the last page*

The layout is achieved with the use of five <div> tags. The divs will each have their own individual style identifiers (ID):

- #wrapper
- #masthead or #banner
- #nav or #menu
- #content
- #footer

The #wrapper will contain the other div tags

## What to do

Think of a subject for your site and commence as though you are going to create a web site with three or so pages. Then create a root folder and do the Manage Sites process in Dreamweaver in the usual way.

In the Files panel create the HTML files for the site and also a folder called CSS.

When you get to the stage of placing content into the page put your own content into the page, don't copy the example above.

## Inserting a div tag

From the Files window open your *index.html* file and click in the design view to insert a div tag using one of the methods illustrated below:

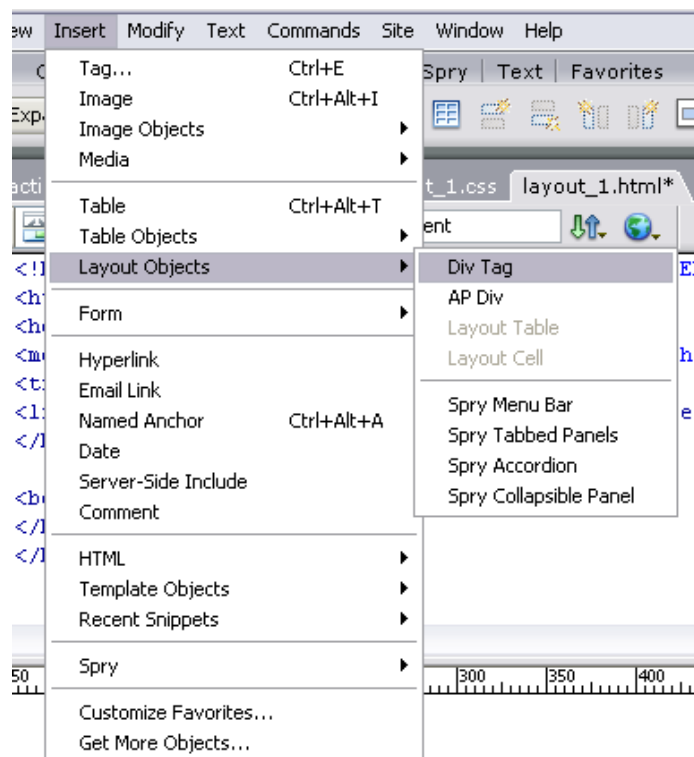

*Menu, Insert > Layout Objects > Div Tag*



*Insert panel, Common section, click on insert Div Tag button*

The following dialogue appears:

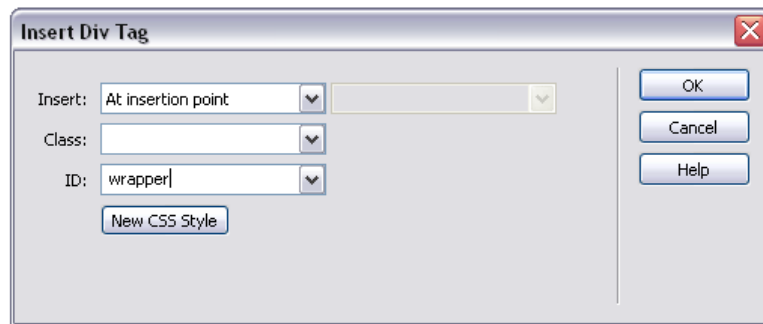

Give the div tag an ID of *wrapper* and click OK. This name will be used in the style sheet to create a style (ID selector) to target this <div> in order to give it position, size and other properties.

After insertion, the <div> appears like this in Split view:

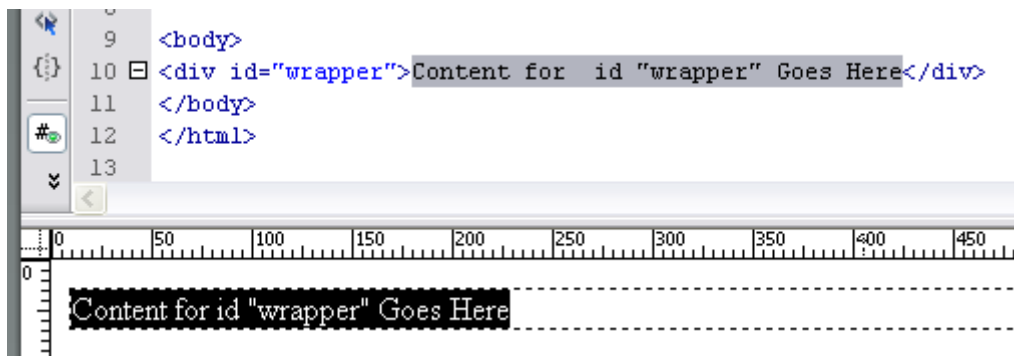

DW fills the <div> with placeholder text for convenient identification.

### Inserting more div tags

Inserting subsequent div tags is best achieved by inserting them in the code. Inserting via the Design view sometimes leads to them being in the wrong place.

All other div tags go inside the *wrapper*. *In the code* click between the end of the placeholder text and the closing </div> and insert another div tag as before (shown below). This time give it an ID of *masthead* or *banner*:

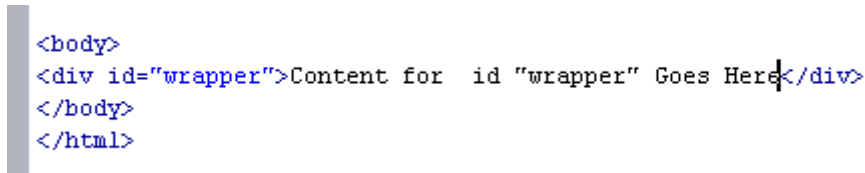

The Split view will now look like this:

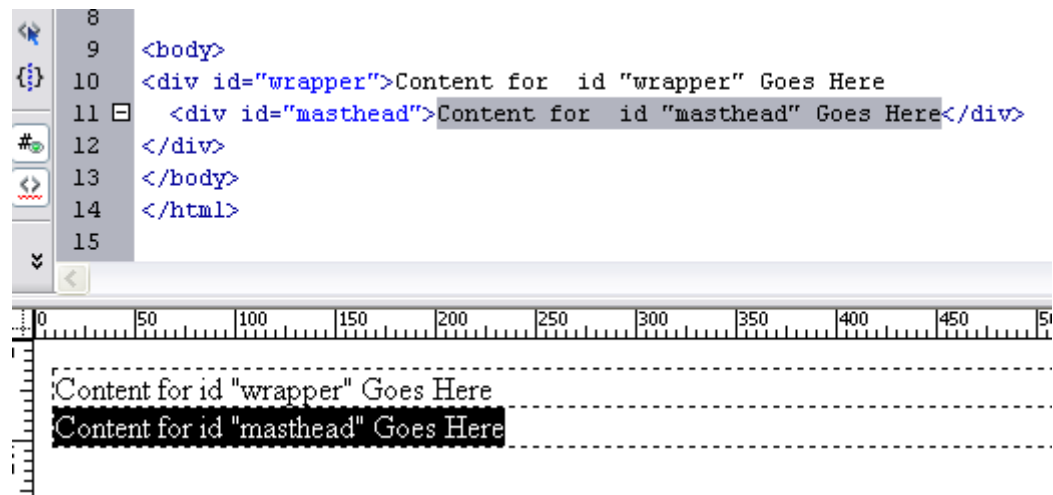

```
8
9 <body>
10 <div id="wrapper">Content for id "wrapper" Goes Here
11 <div id="masthead">Content for id "masthead" Goes Here</div>
12 </div>
13 </body>
14 </html>
15
```

Content for id "wrapper" Goes Here  
Content for id "masthead" Goes Here

In Design view the new div appears as if it is beneath the *wrapper*. In the code view you can see that it is actually nested inside the *wrapper*.

In the previous illustration, the *wrapper* opens on line 10 and closes on line 12 of the code. The *masthead* starts and closes on line 11.

Enter all subsequent div tags at the end of the line of code of the previously entered div tag. In the example above this will be at the end of the line of code on line 11 after `</div>`.

The final result will look like this:

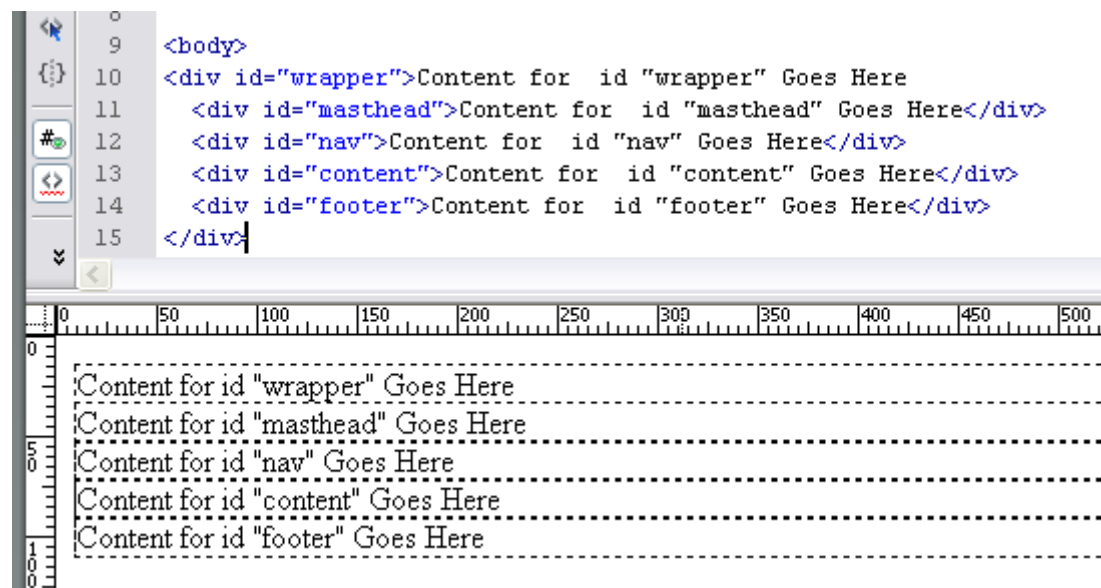

```
9 <body>
10 <div id="wrapper">Content for id "wrapper" Goes Here
11 <div id="masthead">Content for id "masthead" Goes Here</div>
12 <div id="nav">Content for id "nav" Goes Here</div>
13 <div id="content">Content for id "content" Goes Here</div>
14 <div id="footer">Content for id "footer" Goes Here</div>
15 </div>
```

Content for id "wrapper" Goes Here  
Content for id "masthead" Goes Here  
Content for id "nav" Goes Here  
Content for id "content" Goes Here  
Content for id "footer" Goes Here

The illustration above the code shows four `<div>` tags contained within the *wrapper*. The *wrapper* div opens on line 10 and closes on line 15. The contained `<div>` tags occupy one line each. *If your arrangement looks different to this then it could be an indication that the `<div>` tags are inserted incorrectly.*

## Creating styles for the div tags

Create a new style sheet and save it in the `css` folder, naming it as you wish. Make sure it has the `.css` file extension. With `index.html` as the active document click on the Attach Style Sheet button in the CSS Styles panel and attach the style sheet, choosing Media type: Screen.

### #wrapper

The first style to be created is for the `wrapper` div tag. In Design view click on the placeholder text for `wrapper`. In the CSS Styles panel click on the New CSS Rule button. In the New CSS Rule dialogue DW will assume that you wish to create an ID selector for `wrapper`, as in the next illustration:

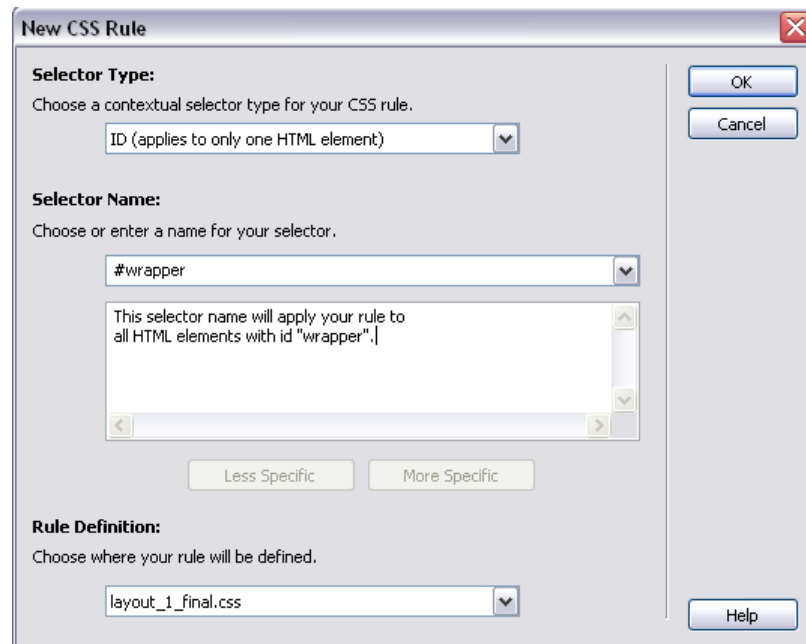

If no name for the selector appears then you will need to type in the selector name. Make sure that the name begins with a hash sign. Ensure your style sheet is defined under Rule Definition and click OK. The CSS Rule Definition dialogue opens.

For this kind of layout, most of the positioning and dimension properties for the div tags are set in the `Box` category. Assuming that the layout is going to be fixed width and centred, enter the values as in the illustration below, plus give the `<div>` a background colour to make it easier to identify on the page.

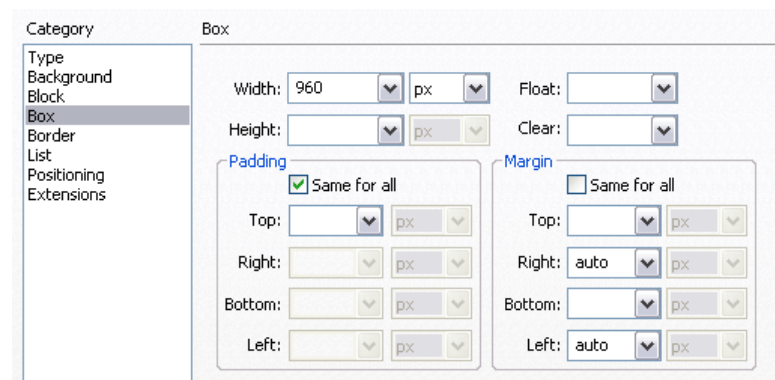

Click on Apply and the layout will be resized and centred. *Choosing auto for Right and Left margins centres the layout within the available space in the browser.* There is no need to specify height as this will be achieved by adding content later.

Finally, go to the Background category and choose a background colour for the div. At this stage, giving each div tag a unique background colour will help with identifying them in the layout. These can be removed or changed later. Click OK and then remove the placeholder text for *wrapper*.

### **#masthead or #banner**

Click on the placeholder text for *masthead/banner* and click on the New CSS Rule button in the CSS Styles panel. The CSS Rule Definition dialogue opens with two ID selectors listed.

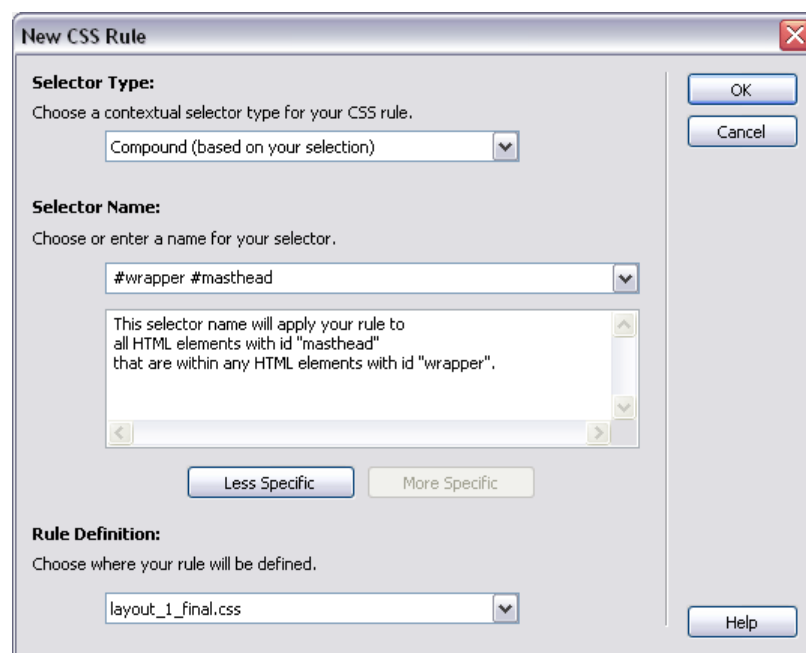

This is because DW has identified two page elements as being chosen. Do one of the following:

- Delete the entry for #wrapper
- OR
- Click on the Less Specific button. This will remove the first entry in this list.

*There is no need to change the Selector Type from Compound to ID as the selector is defined by the hash (#) preceding the name.*

Go to the Box category in the CSS Rule Definition dialogue and enter 960 pixels for the width and choose a background colour.

*It is important to specify a width as not doing so may cause issues with layout.*

### **#nav or #menu**

Following the procedure outlined previously, begin to create a style for *nav/manu*. Set the width to 300 pixels and this time in the Box category

choose *Float > Left*. This will ensure the div stays at the left of the layout. Choose a background colour.

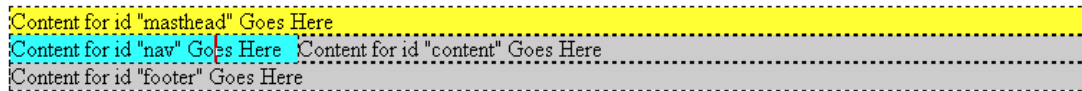

Notice that the *content* div appears to move up to fill the remainder of the space next to the *nav/menu*. What has actually happened is that it has partially slipped up underneath *nav/menu*.

### #content

Following the procedure as before, begin to create a style for *content*. This time set the width for the remainder of the space to the right of *nav/menu*, in this case 660 pixels. At this point click Apply. You will notice that the div does not extend all the way across the layout as part of it is obscured by *nav/menu*.

This is remedied by choosing *Float > Left* in the Box category. The *nav/menu* and *content* are now sitting side by side. This is the technique required to create a columned layout. Give it a background colour.

### #footer

Following the procedure as before, begin to create a style for *footer*. This time, in Box, set the width to 960 pixels and choose *Clear > Both*. This will ensure that the *footer* sits underneath the *nav/menu* and *content* div tags. Give it a background colour.

The *footer* is important for this kind of layout because it ensures that the *wrapper* extends downwards when content is placed inside the other div tags. Without the *footer* the *wrapper* will have no depth. It is also useful for secondary navigation elements, footnotes or to create a visual line underneath the layout. Include the *footer* even if it contains no content. In this case the height can be set to 0 pixels. For the time being, leave out any height considerations.

Your style sheet should now look something like this:

```
#wrapper {
    width: 960px;
    margin-right: auto;
    margin-left: auto;
    background-color: #CCCCCC;
}

#masthead {
    width: 960px;
    background-color: #3CF;
}

#nav {
    width: 300px;
    float: left;
    background-color: #FC6;
}
```

```
#content {
    width: 660px;
    float: left;
    background-color: #CF6;
}

#footer {
    clear: both;
    width: 960px;
    background-color: #F9F;
}
```

The groundwork is now prepared for populating the layout with content.

### Populate the layout with content and apply styling

Tips:

- Values applied for padding and margin will need to be subtracted from the overall dimensions of a contained div tag.
- Size values for borders will need to be subtracted from the overall dimensions of a contained div tag.
- Elements such as headings (h1, h2 etc.) and paragraphs can sometimes create a space top and bottom between div tags. This can be remedied by adding padding to those sides.
- Always preview the work in a browser as some style properties appear differently in Design or Live View in DW.

After populating the layout with content much of the styling can now be achieved by editing the styles for the div tags. For instance, a default text style can be applied via the <body> tag or *wrapper*.

Any default text styling property can be overridden by applying text styling properties to individual div tags within the *wrapper*.

Format the links as a list and create styles to remove bullet points and indentation and so-on.

### Style sheet for the layout on the first page of this handout

```
body {
    margin-top: 20px;
    margin-right: 0px;
    margin-bottom: 20px;
    margin-left: 0px;
}

#wrapper {
    width: 960px;
    margin-right: auto;
    margin-left: auto;
    background-color: #CCCCCC;
    font-family: Arial, Helvetica, sans-serif;
    line-height: 22px;
    font-size: 12px;
}
```

```
#masthead {
    width: 920px;
    padding: 10px 20px;
    background-color: #EEE;
    border-bottom-width: 5px;
    border-bottom-style: solid;
    border-bottom-color: #666666;
    border-top-width: 5px;
    border-top-style: solid;
    border-top-color: #666666;
}

#nav {
    width: 270px;
    float: left;
    padding: 10px 10px 10px 20px;
}

#content {
    width: 578px;
    float: left;
    padding-right: 40px;
    padding-left: 40px;
    text-align: justify;
    background-color: #EEEEEE;
    border-left-width: 2px;
    border-left-style: solid;
    border-left-color: #999999;
}

#footer {
    clear: both;
    width: 920px;
    background-color: #EEE;
    padding: 20px;
    border-top-width: 2px;
    border-bottom-width: 2px;
    border-top-style: solid;
    border-bottom-style: solid;
    border-top-color: #333;
    border-bottom-color: #333;
}

/* Styling for list */
#nav_list {
    margin: 0px;
    padding: 0px;
    list-style-type: none;
}
#nav_list li {
    margin-bottom: 15px;
}

#nav_list li a {
    font-weight: bold;
    font-size: 14px;
    text-decoration: none;
}
```